



Operational Guide

Retractable Barrier



Belt Barrier



WARNING:

- Always ensure the housing unit is attached and locked in position correctly before use.
- Always walk the Belt Barrier back to the fixed housing unit when you release the tape from the receiver. Letting go of the retractable tape from any distance could cause damage to the unit and inflict injury to anything or anyone in its path on its route back to the fixed unit.
- The Belt Barrier is a non impact product, however it has been impact tested and is suitable for light impacts and scrapes by lighter vehicles. If the Belt Barrier is installed to a heavy duty product such as an iFlex Bollard, A-SAFE suggest the installation of the supplied tether. This will stop the unit from coming away from the Bollard in the event of a larger impact.

Belt Barrier - Operational Guide

1

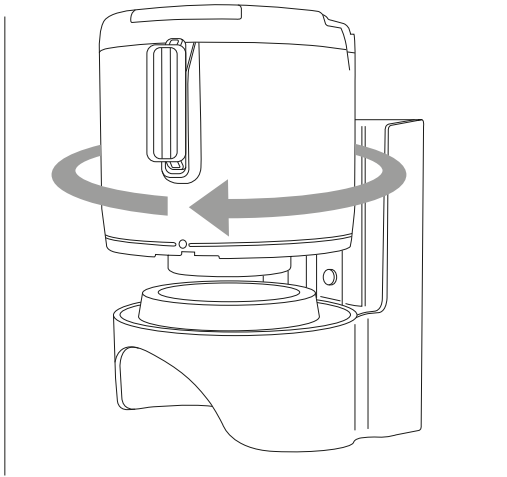

Ensure the Belt Barrier is located and locked correctly into its designed holder.

2

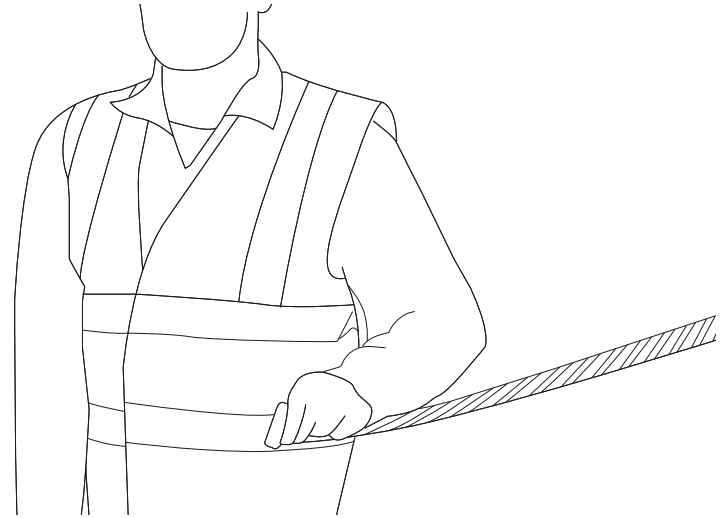

Pull the retractable tape from the unit to the desired length.

3

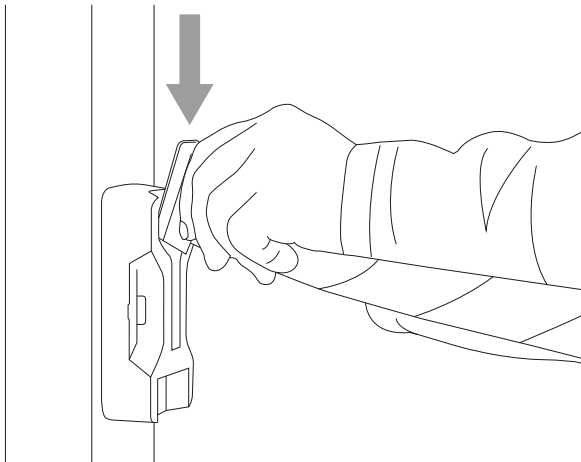

Locate the retractable tape end into the receiver plate ensuring it is pushed to the bottom of the unit.

4

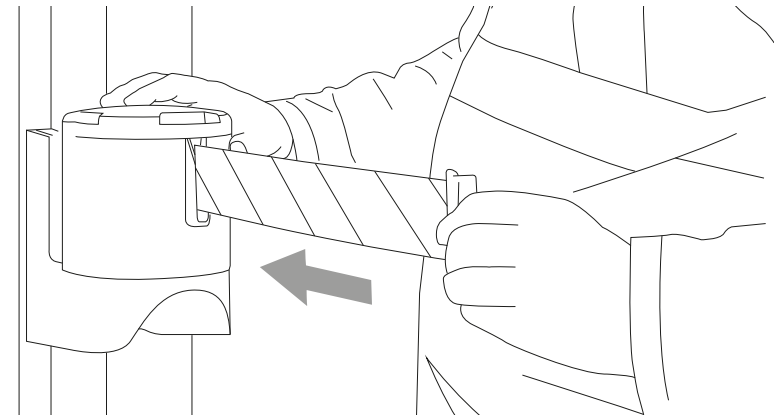

When releasing the retractable tape from the receiver, always walk the tape back to the fixed housing unit. Letting go of the tape from any distance could cause damage to the unit and inflict injury to anything or anyone in its path on its route back to the fixed unit.

This document has been produced by the Product Management Team at A-SAFE HQ.

